



DynaLabs

SENSORS

www.dynalabs-sensors.com

- Analogue Capacitive Accelerometers
 - Digital Capacitive Accelerometers
 - Inertial Measurement Units
 - MEMS Gyroscopes
- 

Our company, Dynalabs, is focused on design and production of dynamic testing and measurement equipment.

We specialize in latest technology MEMS sensors . We have extensive MEMS accelerometer, gyroscope and IMU product line that will meet most of the automotive and aerospace industry needs.

We perform factory calibration of sensors that we produce.

Our company pays great attention to the quality. Dynalabs has CE certificate for sensors.



DynaLabs

SENSORS



1000LN Series - Uniaxial Capacitive Accelerometer

DynaLabs
SENSORS

- Accurate DC measurement
- High shock protection
- Low noise -high resolution
- Differential output signal
- Gas damping

- Structural monitoring and testing
- Aerospace vibration testing
- Automotive ride quality & comfort
- Railway engineering
- GVT and flutter testing



Specifications:

| | | 1002LN | 1005LN | 1010LN | 1030LN | 1050LN | 1100LN | 1200LN |
|----------------------------|----------|----------|----------|----------|----------|----------|----------|----------|
| Full-scale acceleration | (g) | ± 2 | ± 5 | ± 10 | ± 30 | ± 50 | ± 100 | ± 200 |
| Sensitivity | (mV/g) | 1,350 | 540 | 270 | 90 | 54 | 27 | 13.5 |
| Frequency range (±5%) | (Hz) | 700 | 1,150 | 2,000 | 2,300 | 2,700 | 2,900 | 2,500 |
| Non-linearity (full scale) | (%) | 0.15 | 0.15 | 0.15 | 0.15 | 0.15 | 0.15 | 0.15 |
| Noise (in band) | (µg/√Hz) | 9 | 21 | 40 | 100 | 180 | 340 | 680 |
| Bias temperature | (mg/°C) | ± 0.2 | ± 0.5 | ± 1 | ± 3 | ± 5 | ± 10 | ± 20 |
| Shock survivability | (g) | ±3000 pk | ±3000 pk | ±3000 pk | ±3000 pk | ±3000 pk | ±3000 pk | ±3000 pk |

Physical and Environmental

| | |
|---------------------------|----------------------------------|
| Protection Level | IP 68 |
| Operating Voltage | 6 V – 40 V |
| Operating Temperature | -40°C to +100°C |
| Weight (without cable) | 15 g (aluminum) 30 g (steel) |
| Housing Material | Aluminum or Steel |
| Connector(Optional) | D- Sub 9 or 15 pin, Lemo, Binder |
| Mounting | Adhesive or screw mount |
| Base plate (Optional) | Aluminum or Steel |

Technical Drawings:

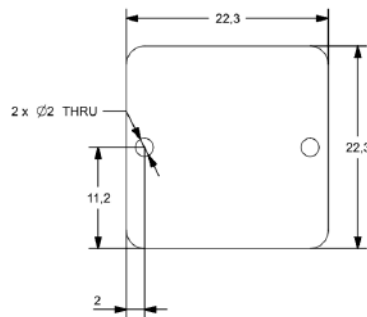
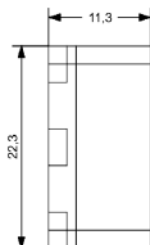
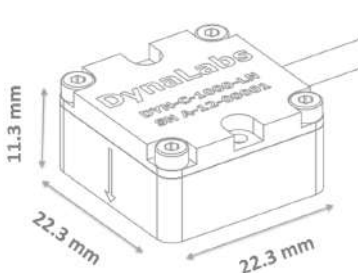

Options:

- Custom Cable Length
- Custom Housing Material
- Custom Connector
- Base plate



- Accurate DC measurement
- High shock protection
- Low noise -high resolution
- Differential-ended output signal
- Gas damping
- Low cost sensors
- Structural monitoring and testing
- Aerospace vibration testing
- Automotive ride quality & comfort
- Railway engineering
- GVT and flutter testing

Specifications:

| | | 1002DE | 1004DE | 1008DE | 1010DE | 1020DE | 1040DE | 1050DE | 1100DE | 1200DE | 1500DE |
|----------------------------|------------------------------------|--------|--------|--------|--------|--------|--------|--------|--------|--------|--------|
| Full-scale acceleration | (g) | ± 2 | ± 4 | ± 8 | ± 10 | ± 20 | ± 40 | ± 50 | ± 100 | ± 200 | ± 500 |
| Frequency range (±3dB) | (Hz) | 1,500 | 1,500 | 1,500 | 1,500 | 1,500 | 1,500 | 3,000 | 3,000 | 3,000 | 3,000 |
| Non-linearity (full scale) | (%) | 0.1 | 0.1 | 0.1 | 0.1 | 0.1 | 0.1 | 0.1 | 0.1 | 0.1 | 0.1 |
| Noise(in band) | ($\mu\text{g}/\sqrt{\text{Hz}}$) | 25 | 25 | 25 | 80 | 75 | 110 | 35 | 50 | 80 | 170 |
| Scale factor (nominal) | (mV/g) | 1,600 | 800 | 400 | 320 | 160 | 80 | 40 | 20 | 10 | 4 |
| Shock survivability | (g) | 5,000 | 5,000 | 5,000 | 5,000 | 5,000 | 5,000 | 6,000 | 6,000 | 6,000 | 6,000 |

Physical and Environmental

| | |
|------------------------|----------------------------------|
| Protection Level | IP 68 |
| Operating Voltage | 6 V – 40 V |
| Operating Temperature | -40°C to +100 °C |
| Weight (without cable) | 25 g (aluminum) 55 g (steel) |
| Housing Material | Aluminum or Steel |
| Connector(Optional) | D- Sub 9 or 15 pin, Lemo, Binder |
| Mounting | Adhesive or screw mount |
| Base plate (Optional) | Aluminum or Steel |

Technical Drawings:

±2g to ±40g:

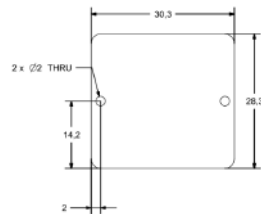
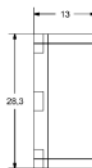
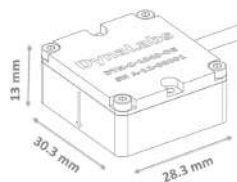

±50g to ±500g:

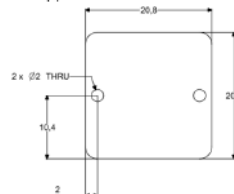
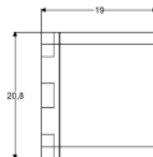
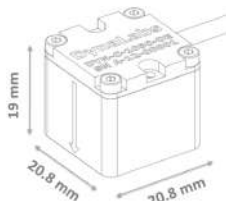

Options:

- Custom Cable Length
- Custom Housing Material
- Custom Connector
- Base plate

1000SE Series - Uniaxial Capacitive Accelerometer

DynaLabs
SENSORS

- Accurate DC measurement
 - High shock protection
 - Low noise -high resolution
 - Single-ended output signal
 - Gas damping
 - Low cost sensors
- Structural monitoring and testing
 - Aerospace vibration testing
 - Automotive ride quality & comfort
 - Railway engineering
 - GVT and flutter testing



Specifications:

| | | 1002SE | 1004SE | 1008SE | 1010SE | 1020SE | 1040SE | 1050SE | 1100SE | 1200SE | 1500SE |
|----------------------------|----------|--------|--------|--------|--------|--------|--------|--------|--------|--------|--------|
| Full-scale acceleration | (g) | ± 2 | ± 4 | ± 8 | ± 10 | ± 20 | ± 40 | ± 50 | ± 100 | ± 200 | ± 500 |
| Frequency range (±3dB) | (Hz) | 1,500 | 1,500 | 1,500 | 1,500 | 1,500 | 1,500 | 3,000 | 3,000 | 3,000 | 3,000 |
| Non-linearity (full scale) | (%) | 0.1 | 0.1 | 0.1 | 0.1 | 0.1 | 0.1 | 0.1 | 0.1 | 0.1 | 0.1 |
| Noise(in band) | (µg/√Hz) | 25 | 25 | 25 | 80 | 80 | 110 | 130 | 220 | 550 | 1,200 |
| Scale factor (nominal) | (mV/g) | 400 | 200 | 100 | 80 | 40 | 20 | 40 | 20 | 10 | 4 |
| Shock survivability | (g) | 5,000 | 5,000 | 5,000 | 5,000 | 5,000 | 5,000 | 6,000 | 6,000 | 6,000 | 6,000 |

Physical and Environmental

| | |
|------------------------|----------------------------------|
| Protection Level | IP 68 |
| Operating Voltage | 6 V – 40 V |
| Operating Temperature | -40°C to +100°C |
| Weight (without cable) | 15 g (aluminum) 25 g (steel) |
| Housing Material | Aluminum or Steel |
| Connector(Optional) | D- Sub 9 or 15 pin, Lemo, Binder |
| Mounting | Adhesive or screw mount |
| Base plate (Optional) | Aluminum or Steel |

Technical Drawings:

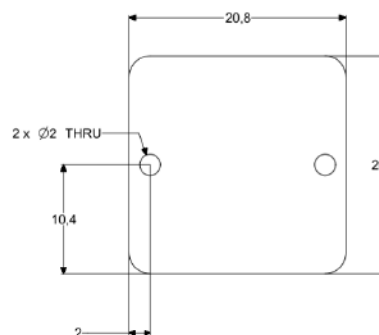
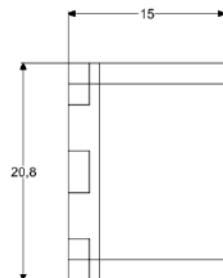
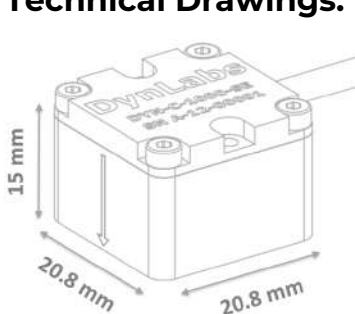

Options:

- Custom Cable Length
- Custom Housing Material
- Custom Connector
- Base plate



- Accurate DC measurement
- High frequency response
- High shock protection
- Low noise -high resolution
- Differential output signal
- Gas damping
- Structural monitoring and testing
- Aerospace vibration testing
- Automotive ride quality & comfort
- Railway engineering
- GVT and flutter testing

Specifications:

| | | 3002LN | 3005LN | 3010LN | 3030LN | 3050LN | 3100LN | 3200LN |
|----------------------------|----------|----------|----------|----------|----------|----------|----------|----------|
| Full-scale acceleration | (g) | ± 2 | ± 5 | ± 10 | ± 30 | ± 50 | ± 100 | ± 200 |
| Sensitivity | (mV/g) | 1,350 | 540 | 270 | 90 | 54 | 27 | 13.5 |
| Frequency range (±5%) | (Hz) | 700 | 1,150 | 2,000 | 2,300 | 2,700 | 2,900 | 2,500 |
| Non-linearity (full scale) | (%) | 0.15 | 0.15 | 0.15 | 0.15 | 0.15 | 0.15 | 0.15 |
| Noise (in band) | (µg/√Hz) | 9 | 21 | 40 | 100 | 180 | 340 | 680 |
| Bias temperature | (mg/°C) | ± 0.2 | ± 0.5 | ± 1 | ± 3 | ± 5 | ± 10 | ± 20 |
| Shock survivability | (g) | ±3000 pk | ±3000 pk | ±3000 pk | ±3000 pk | ±3000 pk | ±3000 pk | ±3000 pk |

Physical and Environmental

| | |
|------------------------|----------------------------------|
| Protection Level | IP 68 |
| Operating Voltage | 6 V – 40 V |
| Operating Temperature | -40°C to +100°C |
| Weight (without cable) | 28 g(aluminum) 55 g (steel) |
| Housing Material | Aluminum or Steel |
| Connector(Optional) | D- Sub 9 or 15 pin, Lemo, Binder |
| Mounting | Adhesive or screw mount |
| Base plate (Optional) | Aluminum or Steel |

Technical Drawings:

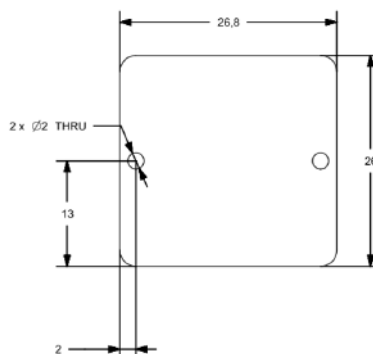
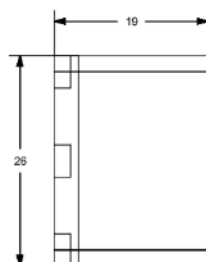
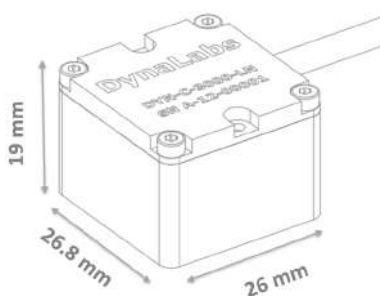

Options:

- Custom Cable Length
- Custom Housing Material
- Custom Connector
- Base plate

3000DE Series - Triaxial Capacitive Accelerometer

DynaLabs
SENSORS

- Accurate DC measurement
- High frequency response
- High shock protection
- Low noise -high resolution
- Differential-ended output signal
- Gas damping

- Structural monitoring and testing
- Aerospace vibration testing
- Automotive ride quality & comfort
- Railway engineering
- GVT and flutter testing



Specifications:

| | | 3002DE | 3004DE | 3008DE | 3010DE | 3020DE | 3040DE | 3050DE | 3100DE | 3200DE | 3500DE |
|----------------------------|----------|--------|--------|--------|--------|--------|--------|--------|--------|--------|--------|
| Full-scale acceleration | (g) | ± 2 | ± 4 | ± 8 | ± 10 | ± 20 | ± 40 | ± 50 | ± 100 | ± 200 | ± 500 |
| Frequency range (±3dB) | (Hz) | 1,500 | 1,500 | 1,500 | 1,500 | 1,500 | 1,500 | 3,000 | 3,000 | 3,000 | 3,000 |
| Non-linearity (full scale) | (%) | 0.1 | 0.1 | 0.1 | 0.1 | 0.1 | 0.1 | 0.1 | 0.1 | 0.1 | 0.1 |
| Noise(in band) | (µg/√Hz) | 25 | 25 | 25 | 80 | 75 | 110 | 35 | 50 | 80 | 170 |
| Scale factor (nominal) | (mV/g) | 1,600 | 800 | 400 | 320 | 160 | 80 | 40 | 20 | 10 | 4 |
| Shock survivability | (g) | 5,000 | 5,000 | 5,000 | 5,000 | 5,000 | 5,000 | 6,000 | 6,000 | 6,000 | 6,000 |

Physical and Environmental

| | |
|------------------------|----------------------------------|
| Protection Level | IP 68 |
| Operating Voltage | 6 V – 40 V |
| Operating Temperature | -40°C to +100°C |
| Weight (without cable) | 25 g (aluminum) 55 g (steel) |
| Housing Material | Aluminum or Steel |
| Connector(Optional) | D- Sub 9 or 15 pin, Lemo, Binder |
| Mounting | Adhesive or screw mount |
| Base plate (Optional) | Aluminum or Steel |

Technical Drawings:

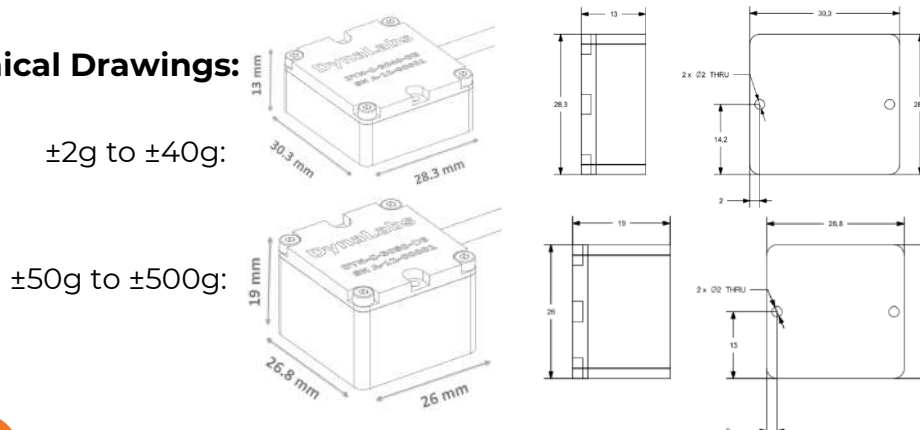

Options:

- Custom Cable Length
- Custom Housing Material
- Custom Connector
- Base plate



- Accurate DC measurement
- High frequency response
- High shock protection
- Low noise -high resolution
- Single-ended output signal
- Gas damping
- Low cost sensors

- Structural monitoring and testing
- Aerospace vibration testing
- Automotive ride quality & comfort
- Railway engineering
- GVT and flutter testing

Specifications:

| | | 3002SE | 3004SE | 3008SE | 3010SE | 3020SE | 3040SE | 3050SE | 3100SE | 3200SE | 3500SE |
|----------------------------|----------|--------|--------|--------|--------|--------|--------|--------|--------|--------|--------|
| Full-scale acceleration | (g) | ± 2 | ± 4 | ± 8 | ± 10 | ± 20 | ± 40 | ± 50 | ± 100 | ± 200 | ± 500 |
| Frequency range (±3dB) | (Hz) | 1,500 | 1,500 | 1,500 | 1,500 | 1,500 | 1,500 | 3,000 | 3,000 | 3,000 | 3,000 |
| Non-linearity (full scale) | (%) | 0.1 | 0.1 | 0.1 | 0.1 | 0.1 | 0.1 | 0.1 | 0.1 | 0.1 | 0.1 |
| Noise(in band) | (µg/√Hz) | 25 | 25 | 25 | 80 | 80 | 110 | 130 | 220 | 550 | 1,200 |
| Scale factor (nominal) | (mV/g) | 400 | 200 | 100 | 80 | 40 | 20 | 40 | 20 | 10 | 4 |
| Shock survivability | (g) | 5,000 | 5,000 | 5,000 | 5,000 | 5,000 | 5,000 | 6,000 | 6,000 | 6,000 | 6,000 |

Physical and Environmental

| | |
|------------------------|----------------------------------|
| Protection Level | IP 68 |
| Operating Voltage | 6 V – 40 V |
| Operating Temperature | -40°C to +100°C |
| Weight (without cable) | 20 g (aluminum) 40 g (steel) |
| Housing Material | Aluminum or Steel |
| Connector(Optional) | D- Sub 9 or 15 pin, Lemo, Binder |
| Mounting | Adhesive or screw mount |
| Base plate (Optional) | Aluminum or Steel |

Technical Drawings:

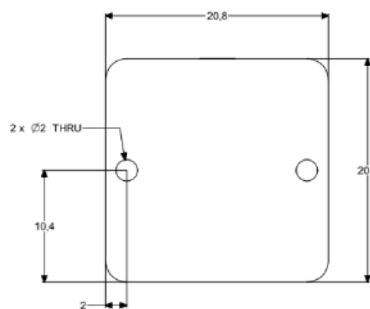
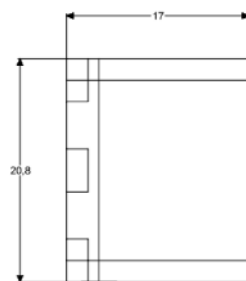
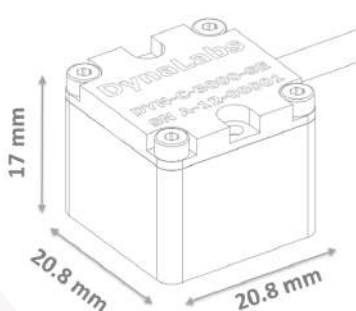

Options:

- Custom Cable Length
- Custom Housing Material
- Custom Connector
- Base plate

- Accurate DC measurement
- Detect dynamic (AC) accelerations with amplitudes
- Reliable, long-term stable, and precise

- Industrial Test & Measurement
- Condition Monitoring
- Robotic and Automation
- Tilt sensing
- Seismic imaging

Software Features:

- Display and record: X,Y,Z acceleration, Temperature
- Analyse: FFT, downsample, average
- Calibration: Linear Equation
- Export: .CSV, .MAT, .TXT, .PNG

Specifications:

| | | ±2 | ±4 | ±8 | ±10 | ±20 | ±40 |
|-------------------------|------------------------------------|-------|-------|--------|-------|-------|-------|
| Sensitivity | ($\mu\text{g}/\text{LSB}$) | 3,906 | 7,812 | 15,625 | 0,195 | 0,390 | 0,781 |
| Sensitivity (Change/°C) | (%/°C) | ±0.01 | ±0.01 | ±0.01 | ±0.01 | ±0.01 | ±0.01 |
| 0 g Offset | (mg) | ±25 | ±25 | ±25 | ±125 | ±125 | ±125 |
| Noise | ($\mu\text{g}/\sqrt{\text{Hz}}$) | 25 | 25 | 25 | 75 | 85 | 90 |
| Non-Linearity | (%) | 0,1 | 0,8 | 1,6 | 0,1 | 0,5 | 1,3 |
| Resolution (1 LSB) | (μg) | 4 | 8 | 16 | 20 | 40 | 80 |

Electrical, Physical and Environmental

| | |
|------------------------|---------------------------------|
| Sensitive Direction | Triaxial |
| Resolution | 4 μg |
| Operating Voltage | 5V - 16 V |
| Measurement Range | ±2g, ±4g, ±8g, ±10g, ±20g, ±40g |
| Sample Rate | 15, 62, 125, 500, 1000 SPS |
| Protection Level | IP 68 |
| Frequency Range (±5 %) | DC to 1000 Hz |
| Base plate (Optional) | Aluminum or Steel |

Technical Drawings:

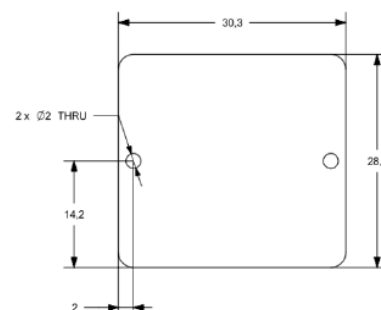
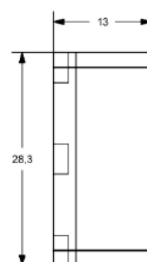
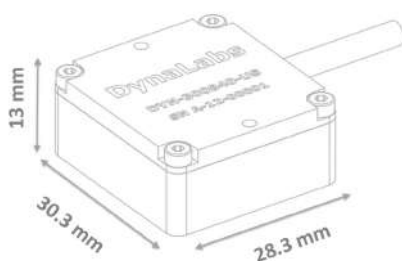

- Accurate DC measurement
- Detect dynamic (AC) accelerations with amplitudes
- Reliable, long-term stable, and precise

- General Industrial Test & Measurement
- Condition Monitoring
- Robotics and Automation
- Tilt sensing
- Seismic imaging

Specifications:

| | | ±2 | ±4 | ±8 | ±10 | ±20 | ±40 |
|-------------------------|----------|--------|--------|--------|-------|-------|-------|
| Scale Factor | (LSB/g) | 256000 | 128000 | 64000 | 51200 | 25600 | 12800 |
| Sensitivity | (µg/LSB) | 3,906 | 7,812 | 15,625 | 0,195 | 0,390 | 0,781 |
| Sensitivity (Change/°C) | (%/°C) | ±0.01 | ±0.01 | ±0.01 | ±0.01 | ±0.01 | ±0.01 |
| 0 g Offset | (mg) | ±25 | ±25 | ±25 | ±125 | ±125 | ±125 |
| Noise | (µg/√Hz) | 25 | 25 | 25 | 75 | 85 | 90 |
| Non-Linearity | (%) | 0,1 | 0,8 | 1,6 | 0,1 | 0,5 | 1,3 |
| Resolution (1 LSB) | (µg) | 4 | 8 | 16 | 20 | 40 | 80 |

Electrical, Physical and Environmental

| | |
|------------------------|---------------------------|
| Sensitive Direction | Triaxial |
| Resolution | 20-bit |
| Protection Level | IP 68 |
| Measurement Range | ±2 to ±40 g (Customize) |
| Sample Rate | 1 to 4000 SPS (Customize) |
| Operating Voltage | 5V - 16 V |
| Frequency Range (±5 %) | DC to 1000 Hz |
| Base plate (Optional) | Aluminum or Steel |

Technical Drawings:

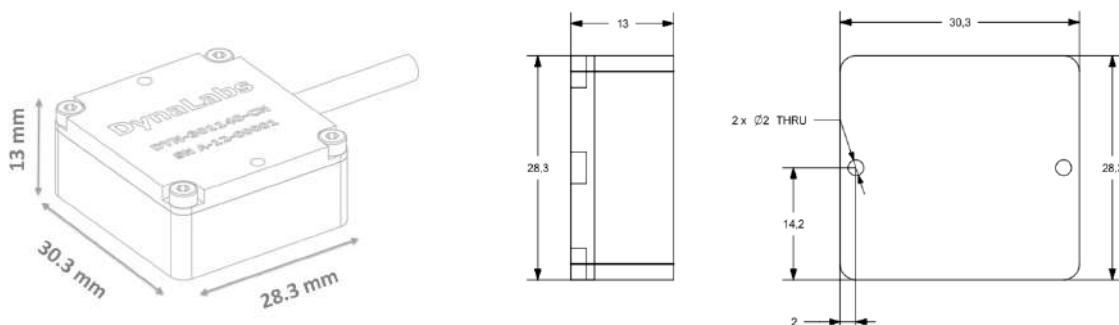

8000 Series - Inertial Measurement Unit (IMU)

- Accurate 6 DOF DC measurement
- High shock and vibration rejection
- Class-leading bias and noise over temperature
- Low noise – high resolution
- Tactical Grade option is available

- Automotive in-car navigation
- Vehicle and personal navigation aiding
- Vehicle yaw, pitch and roll rate sensing
- Antenna stabilization
- Motion control
- Railway engineering



GYROSCOPES

| | | | | | |
|------------------------------|-----------|--------|--------|--------|--------|
| Full-scale angular velocity | (°/s) | ± 75 | ± 150 | ± 300 | ± 900 |
| Frequency range | (Hz) | 0-150 | 0-150 | 0-150 | 0-150 |
| Non-linearity (full scale) | (%) | 0.06 | 0.06 | 0.06 | 0.06 |
| Noise (in band) | (°/s/√Hz) | 0.0075 | 0.0075 | 0.0075 | 0.0075 |
| Scale factor (nominal) | (V/°/s) | 0.012 | 0.006 | 0.003 | 0.001 |
| Scale factor var. over temp. | (%) | 0.5 | 0.5 | 0.5 | 0.5 |
| Bias variation with temp. | (°/s) | ± 1 | ± 2 | ± 3 | ± 4 |

ACCELEROMETERS

| | | | | | | | | |
|----------------------------|----------|-------|-------|-------|-------|-------|-------|-------|
| Full-scale acceleration | (g) | ± 2 | ± 5 | ± 10 | ± 30 | ± 50 | ± 100 | ± 200 |
| Frequency range (±5%) | (Hz) | 700 | 1,150 | 2,000 | 2,300 | 2,700 | 2,900 | 2,500 |
| Non-linearity (full scale) | (%) | 0.15 | 0.15 | 0.15 | 0.15 | 0.15 | 0.15 | 0.15 |
| Noise (in band) | (µg/√Hz) | 9 | 21 | 40 | 100 | 180 | 340 | 680 |
| Scale factor (nominal) | (mV/g) | 1,350 | 540 | 270 | 90 | 54 | 27 | 13.5 |
| Scale factor temp. coeff. | (ppm/°C) | 120 | 120 | 120 | 120 | 120 | 120 | 120 |
| Bias temperature coeff. | (mg/°C) | ± 0.2 | ± 0.5 | ± 1 | ± 3 | ± 5 | ± 10 | ± 20 |

* Any combination of gyroscopes and accelerometers is possible.

Excitation Voltage: 6 to 35VDC.

Technical Drawings:

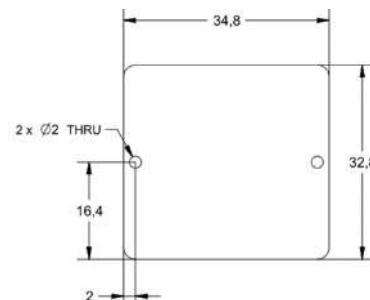
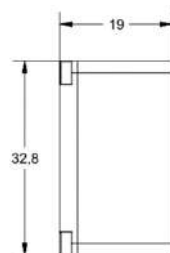
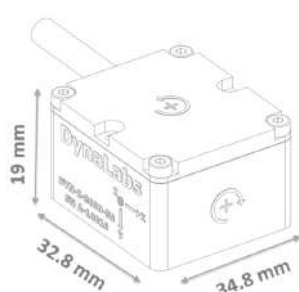

- Custom Cable Length
- Custom Housing Material
- Custom Connector

Weight: 44 g (aluminum)
88 g (steel)



- Accurate 6 DOF DC measurement
- Proven and robust silicon MEMS vibrating ring gyro
- High shock and vibration rejection
- Class-leading bias and noise over temperature
- Low cost – high resolution
- Automotive in-car navigation
- Vehicle and personal navigation aiding
- Vehicle yaw, pitch and roll rate sensing
- Antenna stabilization
- Motion control
- Railway engineering

GYROSCOPES

| | | | | | |
|------------------------------|-----------|--------|--------|--------|--------|
| Full-scale angular velocity | (°/s) | ± 75 | ± 150 | ± 300 | ± 900 |
| Frequency range | (Hz) | 0-150 | 0-150 | 0-150 | 0-150 |
| Non-linearity (full scale) | (%) | 0.06 | 0.06 | 0.06 | 0.06 |
| Noise (in band) | (°/s/√Hz) | 0.0075 | 0.0075 | 0.0075 | 0.0075 |
| Scale factor (nominal) | (V/°/s) | 0.012 | 0.006 | 0.003 | 0.001 |
| Scale factor var. over temp. | (%) | 0.5 | 0.5 | 0.5 | 0.5 |
| Bias variation with temp. | (°/s) | ± 1 | ± 2 | ± 3 | ± 4 |

ACCELEROMETERS

| | | | | | | | | | | | |
|----------------------------|----------|-------|-------|-------|-------|-------|-------|-------|-------|-------|-------|
| Full-scale acceleration | (g) | ± 2 | ± 4 | ± 8 | ± 10 | ± 20 | ± 40 | ± 50 | ± 100 | ± 200 | ± 500 |
| Frequency range (±3dB) | (Hz) | 1,500 | 1,500 | 1,500 | 1,500 | 1,500 | 1,500 | 3,000 | 3,000 | 3,000 | 3,000 |
| Non-linearity (full scale) | (%) | 0.1 | 0.1 | 0.1 | 0.1 | 0.1 | 0.1 | 0.1 | 0.1 | 0.1 | 0.1 |
| Noise (in band) | (µg/√Hz) | 25 | 25 | 25 | 80 | 75 | 110 | 35 | 50 | 80 | 170 |
| Scale factor (nominal) | (mV/g) | 1,600 | 800 | 400 | 320 | 160 | 80 | 80 | 40 | 20 | 8 |

*** Any combination of gyroscopes and accelerometers is possible.**
Excitation Voltage: 6 to 35VDC.

Technical Drawings:

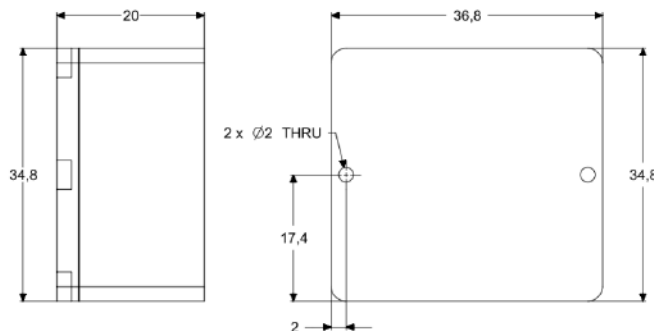
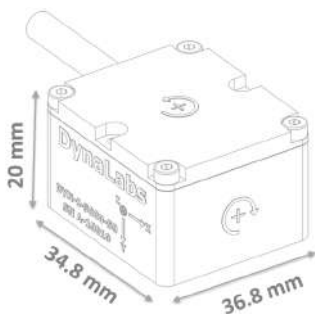

- Custom Cable Length
- Custom Housing Material
- Custom Connector

Weight: 38-42 g (aluminum)
 84-88 g (steel)

Uniaxial - Triaxial Capacitive Gyroscopes

DynaLabs
SENSORS

- Proven and robust silicon MEMS vibrating ring gyro
- High shock and vibration rejection
- Class-leading bias and noise over temperature
- Low noise – high resolution

- Automotive in-car navigation
- GPS vehicle and personal navigation aiding
- Vehicle yaw, pitch and roll rate sensing
- Antenna stabilization
- Motion control



Uniaxial Gyroscopes

| | | DYN-G-6075 | DYN-G-6150 | DYN-G-6300 | DYN-G-6900 |
|------------------------------|-----------|------------|------------|------------|------------|
| Full-scale angular velocity | (°/s) | ± 75 | ± 150 | ± 300 | ± 900 |
| Frequency range | (Hz) | 0-150 | 0-150 | 0-150 | 0-150 |
| Non-linearity (full scale) | (%) | 0.06 | 0.06 | 0.06 | 0.06 |
| Noise (in band) | (°/s/√Hz) | 0.0075 | 0.0075 | 0.0075 | 0.0075 |
| Scale factor (nominal) | (V/°/s) | 0.012 | 0.006 | 0.003 | 0.001 |
| Scale factor var. over temp. | (%) | 0.5 | 0.5 | 0.5 | 0.5 |
| Bias variation with temp. | (°/s) | ± 1 | ± 2 | ± 3 | ± 4 |
| Shock survivability | (g) | 10,000 | 10,000 | 10,000 | 10,000 |

Triaxial Gyroscopes

| | | DYN-G-7075 | DYN-G-7150 | DYN-G-7300 | DYN-G-7900 |
|------------------------------|-----------|------------|------------|------------|------------|
| Full-scale angular velocity | (°/s) | ± 75 | ± 150 | ± 300 | ± 900 |
| Frequency range | (Hz) | 0-150 | 0-150 | 0-150 | 0-150 |
| Non-linearity (full scale) | (%) | 0.06 | 0.06 | 0.06 | 0.06 |
| Noise (in band) | (°/s/√Hz) | 0.0075 | 0.0075 | 0.0075 | 0.0075 |
| Scale factor (nominal) | (V/°/s) | 0.012 | 0.006 | 0.003 | 0.001 |
| Scale factor var. over temp. | (%) | 0.5 | 0.5 | 0.5 | 0.5 |
| Bias variation with temp. | (°/s) | ± 1 | ± 2 | ± 3 | ± 4 |
| Shock survivability | (g) | 10,000 | 10,000 | 10,00€ | 10,000 |

Weight 6000 Series: 12 g (aluminum), 25 g (steel)- Weight 7000 Series: 18 g (aluminum), 35 g (steel)

Excitation Voltage: 6 to 35VDC.

6000 Series Technical Drawing

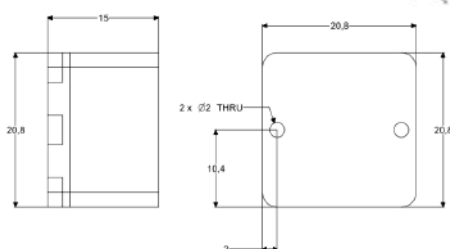

7000 Series Technical Drawing

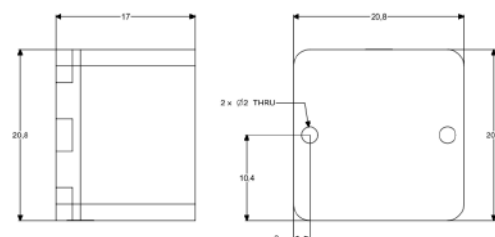

- Custom Cable Length
- Custom Housing Material
- Custom Connector

DynaLabs

www.dynalabs-sensors.com

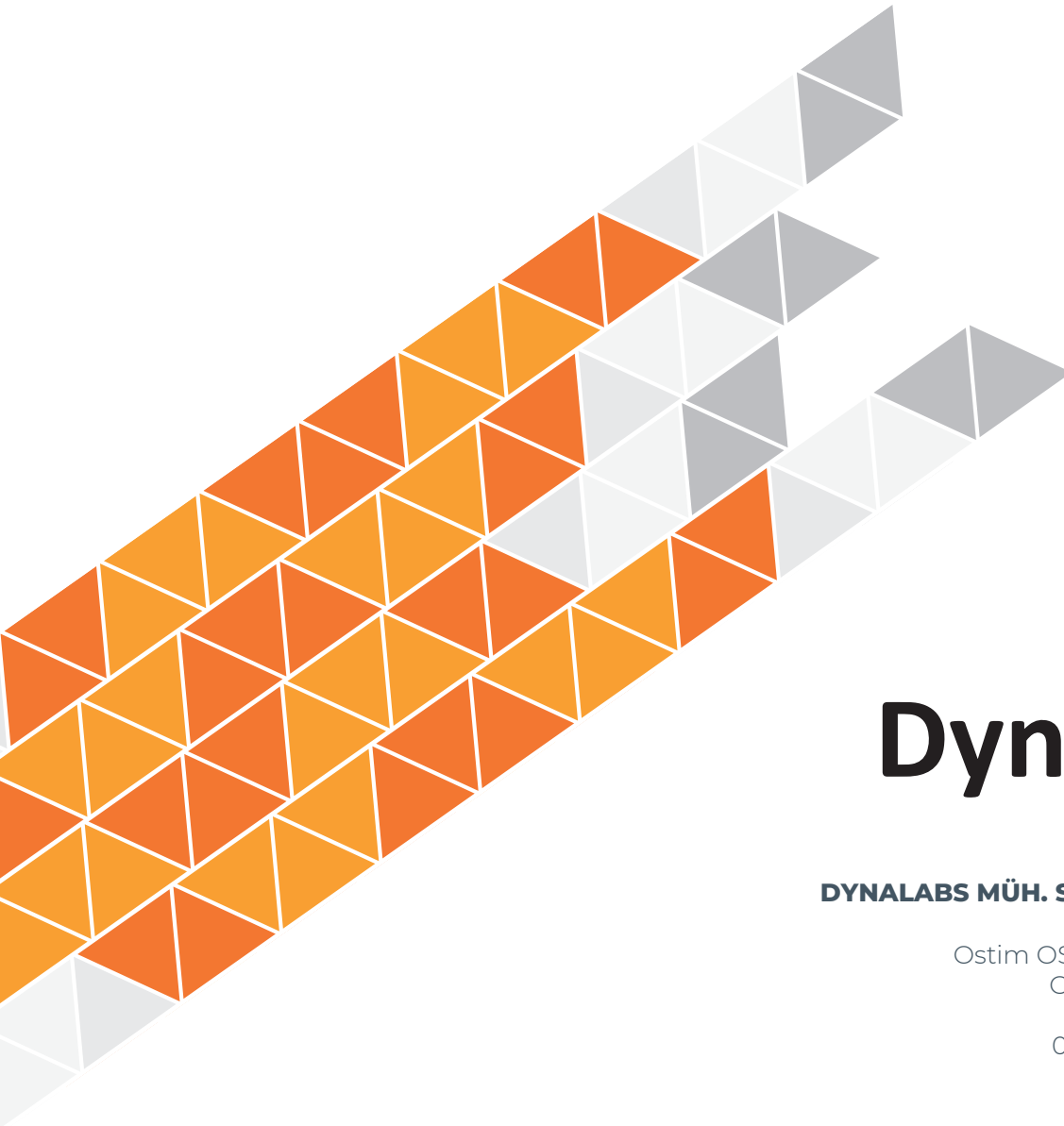

DynaLabs

DYNALABS MÜH. SAN. VE TİC. LTD. ŞTİ.

Ostim OSB Mah. 100. Yıl Bulvarı
Ostim Prestij İş Merkezi
No:55B/11 Yenimahalle
06374 Ankara/ TURKEY

info@dynalabs.com.tr
www.dynalabs.com.tr